



CALDER STREET, COATBRIDGE OFFERS OVER £375,000 Freehold

Kirkland Estate Agents are proud to present to the market this impressive detached family home, wonderfully placed upon an abundance of surrounding land.

Kirkland Estate Agents are thrilled to present this grand detached villa, a truly unique detached property in Coatbridge. Could this be your perfect home for your growing family? Please get in touch now to find out!

This Victorian property is presented in fantastic condition throughout with a perfect layout for quality family life.

The ground floor offers two spacious front facing reception rooms, with beautiful features including ceiling beams and full length green slate fireplace to the left of the wide entrance hall and a Portuguese Marble fireplace with a living flame gas fire to the right. A very large kitchen with open plan dining area to the rear of the house, storage area/cloakroom , WC and large patio door with access to the extensive impressive lawned garden space complete this level.

The upper level of this home offers a spacious hall landing, 4 double bedrooms, a toilet and large fully tiled family bathroom with jacuzzi bath and large shower cubicle.

Three of the bedrooms have large inbuilt sliding door wardrobes offering great storage. The bedrooms and are incredibly spacious as you can see from the video and photographs .

To compliment the house a very large, wall and fenced secure family friendly garden with mature trees is included. A large low maintenance driveway to the front and side of the house, 2 attached outhouses complete this rarely available opportunity . Intrigued? Come and see for yourself.

To arrange viewings or to receive a Home Report please contact our Coatbridge or Uddingston office.

Tenure: Freehold



CALDER STREET, COATBRIDGE
OFFERS OVER £375,000 Freehold



Ground Floor
Approximate Floor Area
1,027 sq.ft.
(95.4 sq.m.)

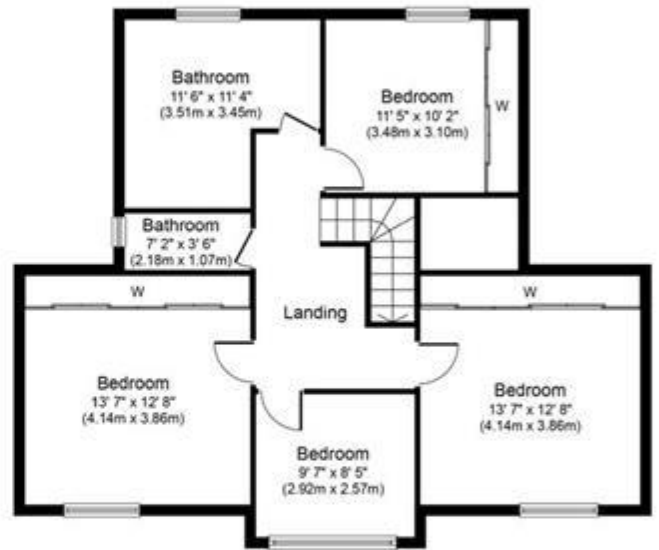

First Floor
Approximate Floor Area
856 sq.ft.
(79.5 sq.m.)

Whilst every attempt has been made to ensure the accuracy of the floor plan contained here, measurements of doors, windows, rooms and any other items are approximate and no responsibility is taken for any error, omission, or mis-statement. The measurements should not be relied upon for valuation, transaction and/or funding purposes. This plan is for illustrative purposes only and should be used as such by any prospective purchaser or tenant. The services, systems and appliances shown have not been tested and no guarantee as to their operability or efficiency can be given.
 Copyright V360 Ltd 2023 | www.houseviz.com



Whilst every effort is made to ensure the accuracy of these details, it should be noted that the measurements are approximate only. Floorplans are for representation purposes only and prepared according to the RICS Code of Measuring Practice by our floorplan provider. Therefore, the layout of doors, windows and rooms are approximate and should be regarded as such by any prospective purchaser. Any internal photographs are intended as a guide only and it should not be assumed that any of the furniture/fittings are included in any sale. Where shown, details of lease, ground rent and service charge are provided by the vendor and their accuracy cannot be guaranteed, as the information may not have been verified and further checks should be made either through your solicitor/conveyance. Where appliances, including central heating, are mentioned, it cannot be assumed that they are in working order, as they have not been tested. Please also note that wiring, plumbing and drains have not been checked.