



ROMAN ROAD, MOTHERWELL OFFERS OVER £85,000

Kirkland Estate Agents are proud to present to the market this lower apartment situated within close proximity of Motherwell Town Centre and is sure to appeal to a whole host of buyers.

Kirkland Estate Agents are proud to present to the market this lower apartment situated within close proximity of Motherwell Town Centre and is sure to appeal to a whole host of buyers.

The property comprises; front facing lounge, two good sized bedrooms with storage, fitted kitchen with appliances and newly fitted shower room.

The outside space of the property has, large patio area to the rear and a communal driveway to the side.

The property is centrally placed for all local amenities including excellent schools, shops, supermarkets, bars, restaurants and recreational facilities. The area benefits from excellent public transport links with bus stops and Shieldmuir and Motherwell railway stations just a short distance away, and for those commuting by car, the M74 motorway offering links to the M8 is again just minutes away.



ROMAN ROAD, MOTHERWELL
OFFERS OVER £85,000

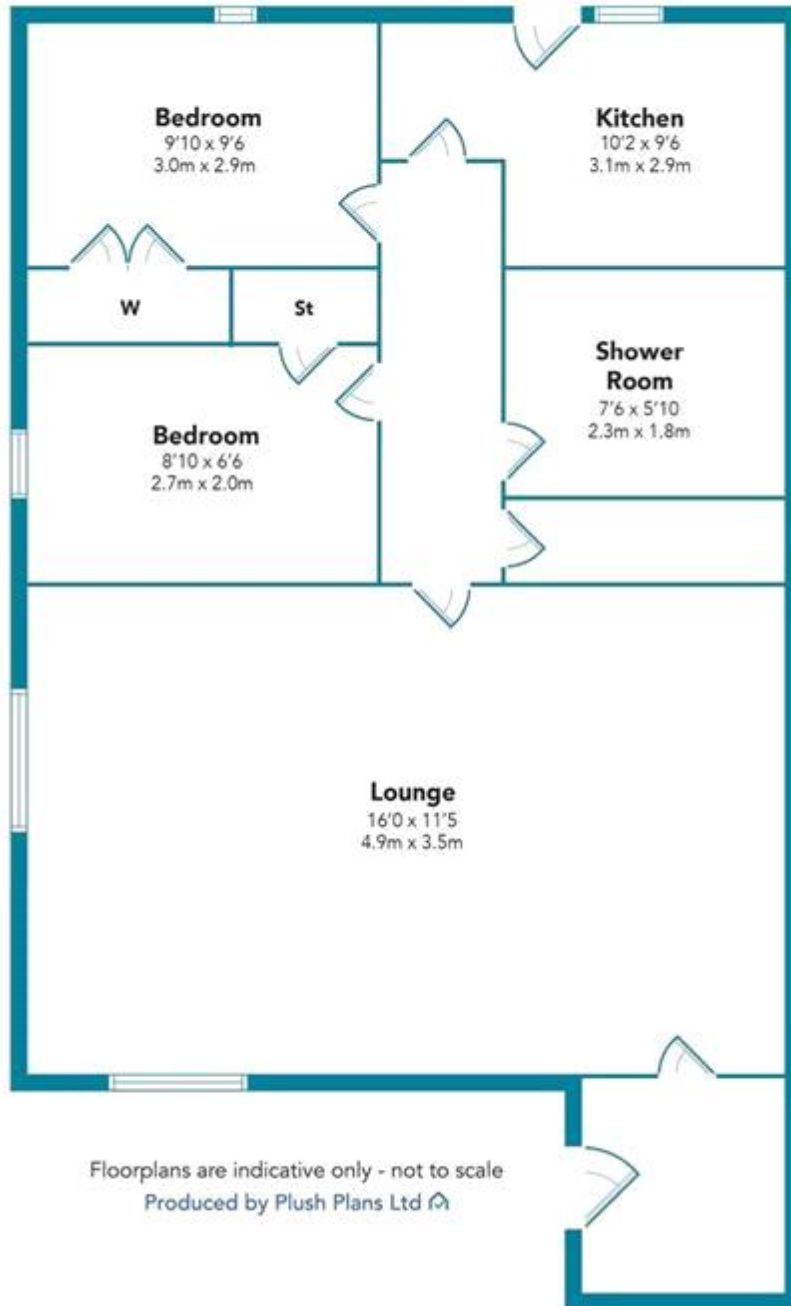

Floorplans are indicative only - not to scale
Produced by Plush Plans Ltd

