



BROOMKNOWE, BLAIR ROAD, CROSSFORD, CARLUKE

OFFERS OVER £349,000

Fabulous opportunity to build your own bespoke home, on a spectacular site with wonderful open aspects over the desirable Clyde Valley by Crossford.

Fabulous opportunity to build your own bespoke home, on a spectacular site with wonderful open aspects over the desirable Clyde Valley by Crossford.

The whole site is approximately 8.5 acres, a good balance of open space and woodland, leading down to the River Nethan.

Full detailed planning permission has been granted (details on the South Lanarkshire Planning Portal, application P/21/2109) for a one and a half story, 3900sqft home, with a detached double garage.

All the services are on site, electricity, mains water and a septic tank, also BT line with fibre connection.

Also included in the sale is a fabulous 4 bedroom log cabin, which you can live in while building your dream home.

The site is located on the edge of Crossford, a highly desirable area in the Clyde Valley. The village has a modern primary school, village shop with post office, dental practice and ample outdoor space along the River Clyde, popular with walkers and outdoor enthusiasts. A great variety of garden centres within a couple of miles, with restaurants and cafes, always popular.

An excellent area for the commuter who needs to access the central belt of Scotland, both Edinburgh and Glasgow airports are around 45minutes by car. The M74 is only a ten minute drive from Crossford, providing access North and South, the nearest train station is in Carluke, again a short drive.



BROOMKNOWE, BLAIR ROAD, CROSSFORD, CARLUKE
OFFERS OVER £349,000

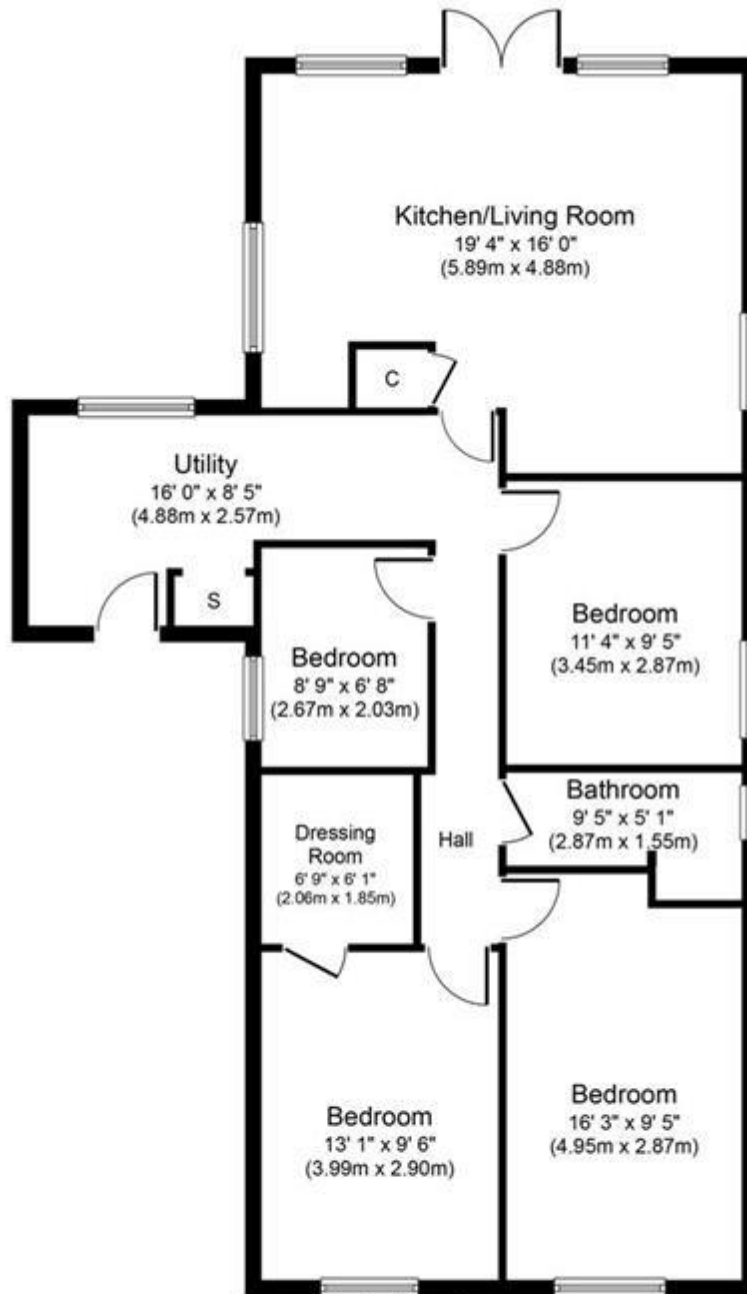

Approximate Floor Area
1,008 sq. ft.
(93.6 sq. m.)

Whilst every attempt has been made to ensure the accuracy of the floor plan contained here, measurements of doors, windows, rooms and any other items are approximate and no responsibility is taken for any error, omission, or mis-statement. The measurements should not be relied upon for valuation, transaction and/or funding purposes. This plan is for illustrative purposes only and should be used as such by any prospective purchaser or tenant. The services, systems and appliances shown have not been tested and no guarantee as to their operability or efficiency can be given.
Copyright V360 Ltd 2023 | www.houseviz.com



Whilst every effort is made to ensure the accuracy of these details, it should be noted that the measurements are approximate only. Floorplans are for representation purposes only and prepared according to the RICS Code of Measuring Practice by our floorplan provider. Therefore, the layout of doors, windows and rooms are approximate and should be regarded as such by any prospective purchaser. Any internal photographs are intended as a guide only and it should not be assumed that any of the furniture/fittings are included in any sale. Where shown, details of lease, ground rent and service charge are provided by the vendor and their accuracy cannot be guaranteed, as the information may not have been verified and further checks should be made either through your solicitor/conveyance. Where appliances, including central heating, are mentioned, it cannot be assumed that they are in working order, as they have not been tested. Please also note that wiring, plumbing and drains have not been checked.