



WOODLANDS CRESCENT, BOTHWELL, GLASGOW OFFERS OVER £210,000

UNDER OFFER

Situated within a peaceful address in Bothwell benefiting from a highly central position, this substantial three bedroom semi-detached villa offers bright, comfortable family accommodation in immaculate condition ready to move into immediately.

Situated within a peaceful address in Bothwell benefiting from a highly central position, this substantial three bedroom semi-detached villa offers bright, comfortable family accommodation in immaculate condition ready to move into immediately.

Features include gas central heating, double glazing and ample storage. Positioned to the front of the property is a slabbed driveway & lawn whilst the rear offers a superb spacious enclosed garden which is predominately lawned with artificial grass and decking area perfect for entertaining.

The accommodation in full comprises; welcoming entrance hallway, forward facing lounge, stylish fully fitted kitchen with access to rear garden and third bedroom. The upper level provides two well proportioned bedrooms, bathroom and large storage cupboard.

Bothwell remains one of South Lanarkshire's most popular villages and is regarded as an up-market and cosmopolitan location. Offering an excellent selection of bars and restaurants, Bothwell boasts fantastic nightlife as well as a charming collection of local shops and boutiques which combine to form an interesting high street. There is a Marks & Spencer's food store within just a few minutes of the property as well as leisure facilities that include 18 hole Bothwell Castle Golf Course, Rail Station at Uddingston and David Lloyd Leisure centre in Hamilton. The property is also only a five minute walk from two highly regarded primary schools. Bothwell offers fast access to the M74 motorway at which recent improvement works have greatly improved the flow of traffic to and from the motorway.



WOODLANDS CRESCENT, BOTHWELL, GLASGOW
OFFERS OVER £210,000

GROUND FLOOR

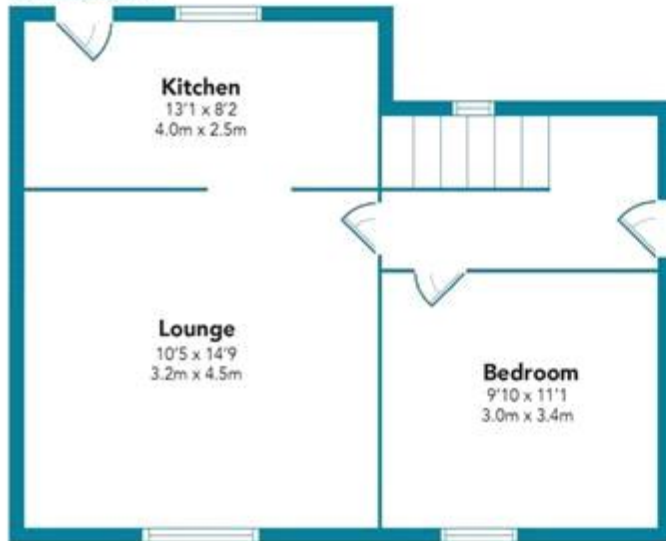

FIRST FLOOR



Floorplans are indicative only - not to scale
Produced by Plush Plans Ltd



Whilst every effort is made to ensure the accuracy of these details, it should be noted that the measurements are approximate only. Floorplans are for representation purposes only and prepared according to the RICS Code of Measuring Practice by our floorplan provider. Therefore, the layout of doors, windows and rooms are approximate and should be regarded as such by any prospective purchaser. Any internal photographs are intended as a guide only and it should not be assumed that any of the furniture/fittings are included in any sale. Where shown, details of lease, ground rent and service charge are provided by the vendor and their accuracy cannot be guaranteed, as the information may not have been verified and further checks should be made either through your solicitor/conveyance. Where appliances, including central heating, are mentioned, it cannot be assumed that they are in working order, as they have not been tested. Please also note that wiring, plumbing and drains have not been checked.