



NETHERHOUSE AVENUE, COATBRIDGE OFFERS OVER £92,500

This well proportioned mid terraced villa is positioned within the popular Kirkshaws location of Coatbridge and is ideal for a family or first time buyer.

This well proportioned mid terraced villa is positioned within the popular Kirkshaws location of Coatbridge and is ideal for a family or first time buyer.

This well proportioned family home has been well maintained and comprises reception hall, bright and airy lounge, fitted kitchen, two double bedrooms and a family bathroom. Features include quality floor coverings, gas central heating and double glazing.

The floor plan shall provide you with a detailed layout of this well laid out and comfortable home; however, we recommend viewing to appreciate all that's on offer.

Coatbridge has the majority of everyday shopping needs and there is a great choice of restaurants, bistros and pubs. The property is located within school catchments for Kirkshaws and St Timothy's Primary Schools and for those commuting by public transport there are regular bus and train services from Coatbridge to the surrounding towns and cities including Glasgow and Edinburgh. For those commuting by car, the M74 and M8 motorways provide excellent access to the central belt linking the surrounding towns and cities.



NETHERHOUSE AVENUE, COATBRIDGE
OFFERS OVER £92,500

GROUND FLOOR

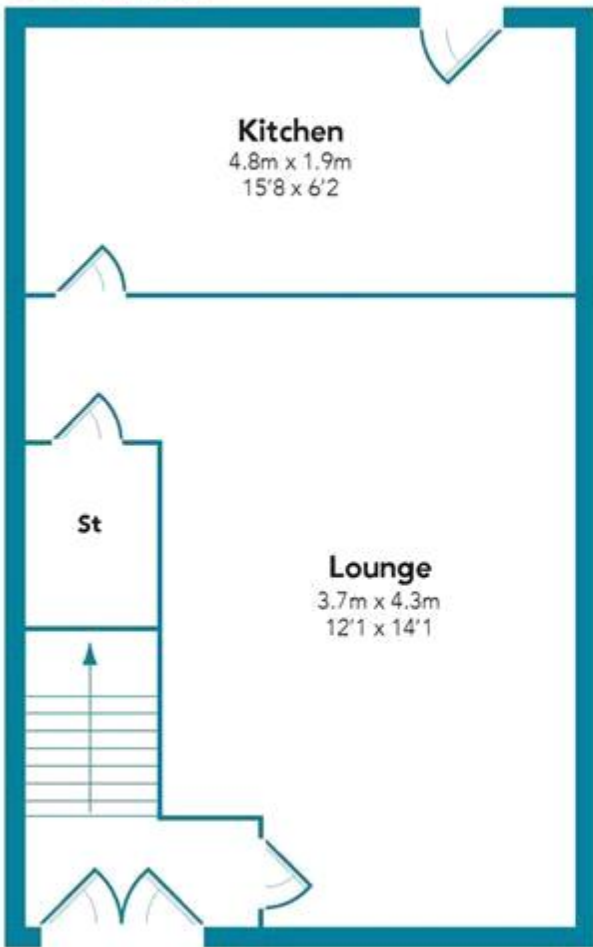

FIRST FLOOR

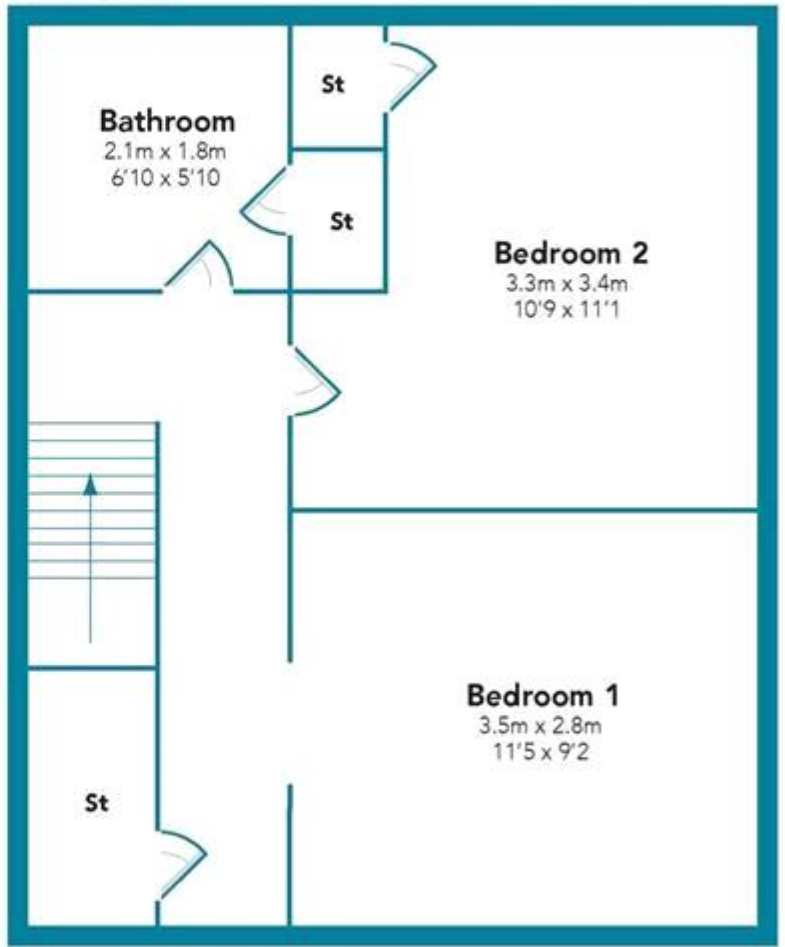

Floorplans are indicative only - not to scale

Produced by Plush Plans Ltd 

