



HIGHBURY GROVE, EAST KILBRIDE, GLASGOW OFFERS OVER £310,000

Kirkland Estate Agents are proud to present to the market this lovely three bedroom detached family home, recently built by Barrett Homes and is situated within this newly built development within Jackton, East Kilbride.

Kirkland Estate Agents are proud to present to the market this impressive three bedroom detached family home, recently built by Barrett Homes and situated within the newly built development in Jackton, East Kilbride.

The property has ample living space throughout and is sure to appeal to a wide range of buyers. With the ground floor of the property comprising; reception hallway with storage, front facing lounge, kitchen with generous dining & living space providing access to the rear garden. The property also benefits from a utility area and downstairs W/C.

Upstairs there are three good sized bedrooms and a modern family bathroom. The master bedroom including en suite with shower. There is a driveway at the front of the property with lawn area and a generous back garden.

The location of this property offers an array of leisure, shopping and dining activities nearby. East Kilbride's shopping centre and the St. James retail park are less than 10 minutes' drive away, Giffnock and Newton Mearns offer further shopping and leisure experiences including Parklands Country Club and Spa. Whitecraigs, Rouken Glen and Cathcart Golf clubs are within a short drive as is the popular David Lloyd leisure complex.

Glasgow's south side is also easily accessible and boasts some of the best restaurants and bars in the city.



HIGHBURY GROVE, EAST KILBRIDE, GLASGOW
OFFERS OVER £310,000

GROUND FLOOR

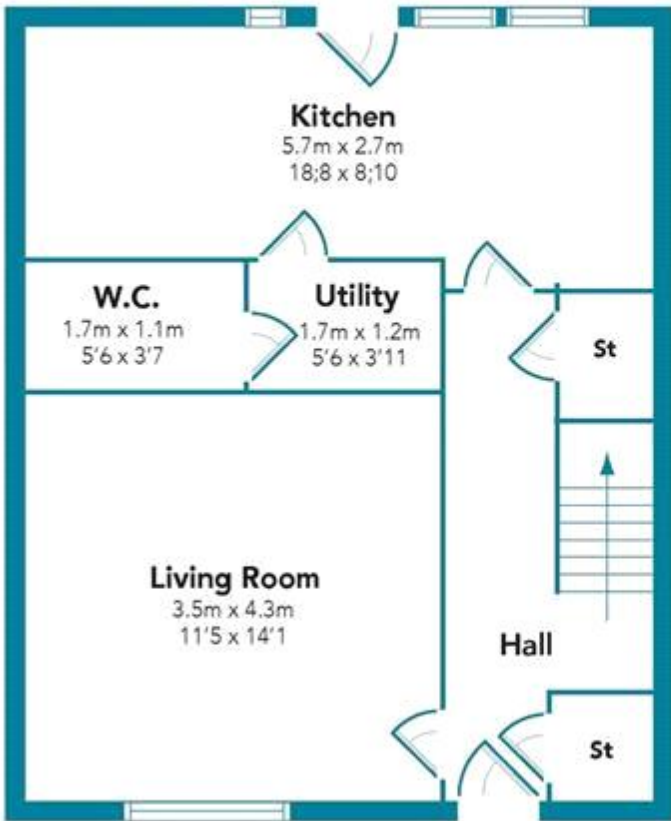

FIRST FLOOR

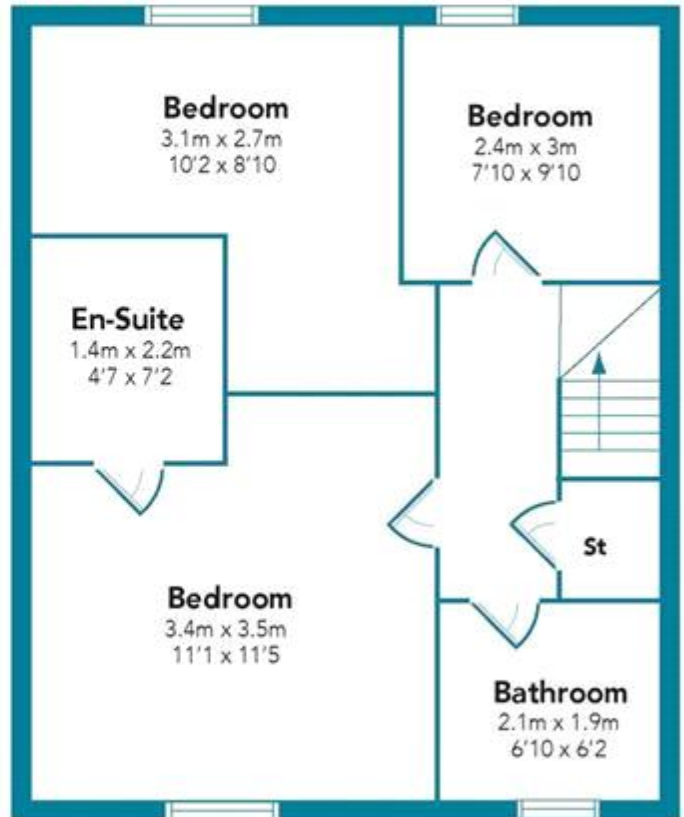

Floorplans are indicative only - not to scale
Produced by Plush Plans Ltd 



Whilst every effort is made to ensure the accuracy of these details, it should be noted that the measurements are approximate only. Floorplans are for representation purposes only and prepared according to the RICS Code of Measuring Practice by our floorplan provider. Therefore, the layout of doors, windows and rooms are approximate and should be regarded as such by any prospective purchaser. Any internal photographs are intended as a guide only and it should not be assumed that any of the furniture/fitings are included in any sale. Where shown, details of lease, ground rent and service charge are provided by the vendor and their accuracy cannot be guaranteed, as the information may not have been verified and further checks should be made either through your solicitor/conveyance. Where appliances, including central heating, are mentioned, it cannot be assumed that they are in working order, as they have not been tested. Please also note that wiring, plumbing and drains have not been checked.