



ROCKBURN CRESCENT, BELLSHILL OFFERS OVER £149,995

Situated in a sought-after location just off the North Road and within walking distance of Noble Primary and St. Gerards Primary, this beautifully presented two bedroom semi detached villa will appeal to a wide range of buyers. EPC Rating D.

Situated in a sought-after location just off the North Road and within walking distance of Noble Primary and St. Gerards Primary, this beautifully presented two bedroom semi detached villa will appeal to a wide range of buyers.

The property is an ideal family home that offers a well-proportioned layout of apartments and in brief comprises an entrance hall with staircase leading to the upper floor level, generously sized bay windowed lounge, cloakroom/wc, fabulous modern kitchen and a rear hallway with door access to the driveway and garden.

Upstairs, there are 2 great sized double bedrooms both with ample space for free standing bedroom furniture and, a fully tiled modern bathroom with white suite, shower over the bath, glass screen, and ladder style towel radiator. In addition, the property benefits from gas central heating, double glazing and fresh decor throughout.

Outside, the gated driveway has space for several cars and leads to a large single car garage with mains power. The rear garden has been laid with artificial grass bordered by decorative paving and boasts a large decking area, perfect for al-fresco entertaining.

Conveniently situated for both the M74 and the M8, making it an excellent base for travel throughout the central belt as well as to the centre of Glasgow. Local amenities include bus and train links, sports facilities, and shopping areas as well as excellent nursery, primary and secondary schools available nearby.



ROCKBURN CRESCENT, BELLSHILL
OFFERS OVER £149,995

GROUND FLOOR

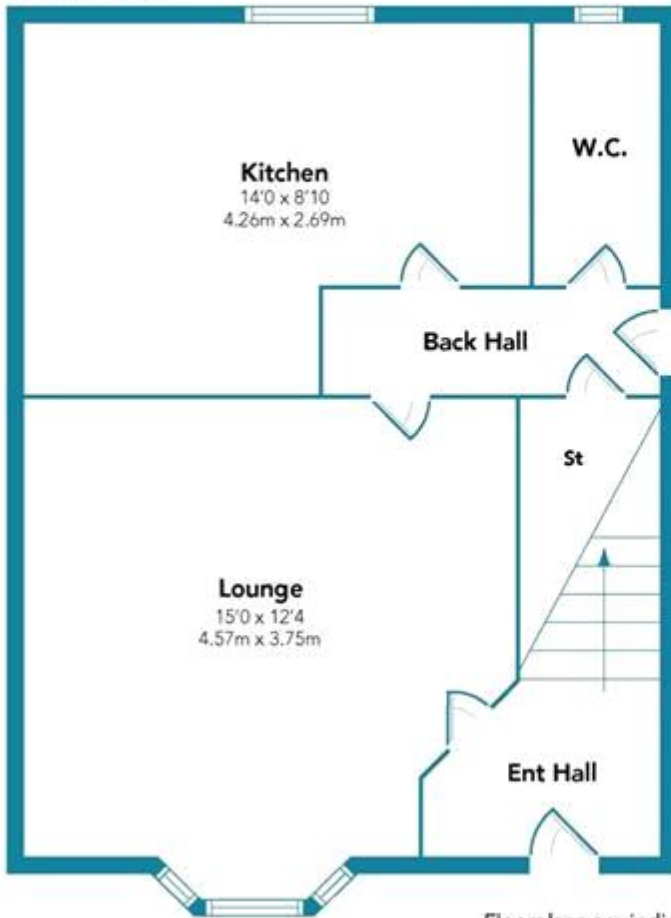

FIRST FLOOR

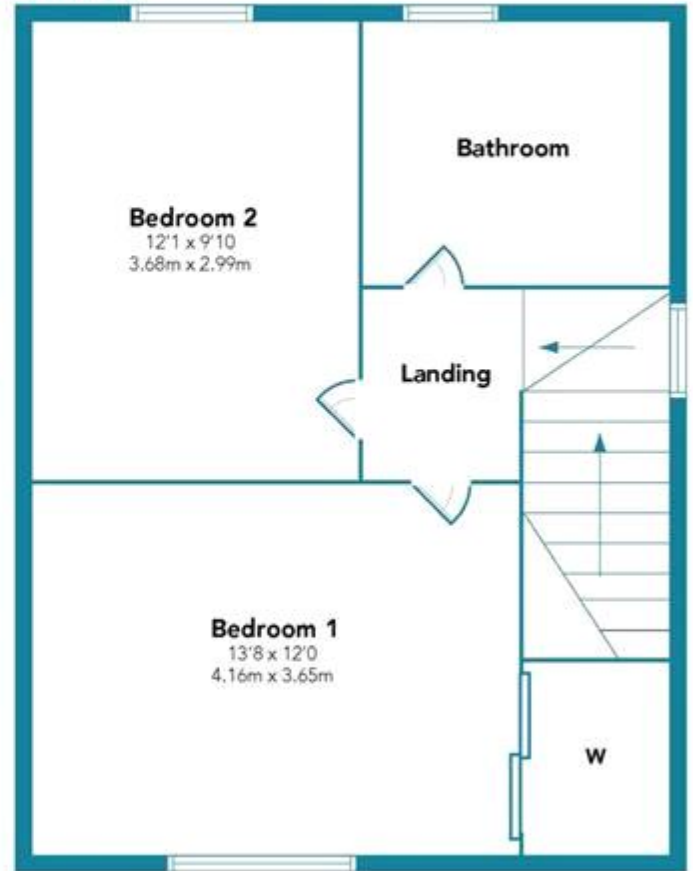

Floorplans are indicative only - not to scale
Produced by Plush Plans Ltd

Map error: g.co/staticmaperror

