



## THORNDYKE, EAST KILBRIDE, GLASGOW OFFERS OVER £85,000

Kirkland Estate Agents are proud to present to the market this beautifully proportioned top floor flat which is presented in walk in condition throughout. While also including its very own garage.

Kirkland Estate Agents are proud to present to the market this beautifully proportioned top floor flat which is presented in walk in condition throughout.

The property has been neutrally decorated throughout and finished with quality fixtures and fittings. The accommodation comprises; welcoming entrance hallway with large storage cupboard, modern fitted kitchen, two double bedrooms and modern family bathroom.

Further features include double glazing, gas central heating and secure door entry and garage.

The enclosed floor plan shall provide a detailed layout of the accommodation. However, we recommend early viewing to appreciate the accommodation on offer.

East Kilbride offers a range of primary and secondary schooling, and South Lanarkshire College located in the town also. It is one of Scotland's largest and newest towns enjoying a central locale with ample bus and rail services and motorway links providing access in and around the central belt. The town also boasts a wide and varied range of shopping centres, retail parks, bars, restaurants and night life. Some of the local amenities include a multiplex cinema, ice rink, the Arts Centre, the Dollan Aqua Centre, as well as several Sports Centres, Golf Courses and numerous other recreational facilities.



THORNDYKE, EAST KILBRIDE, GLASGOW  
OFFERS OVER £85,000

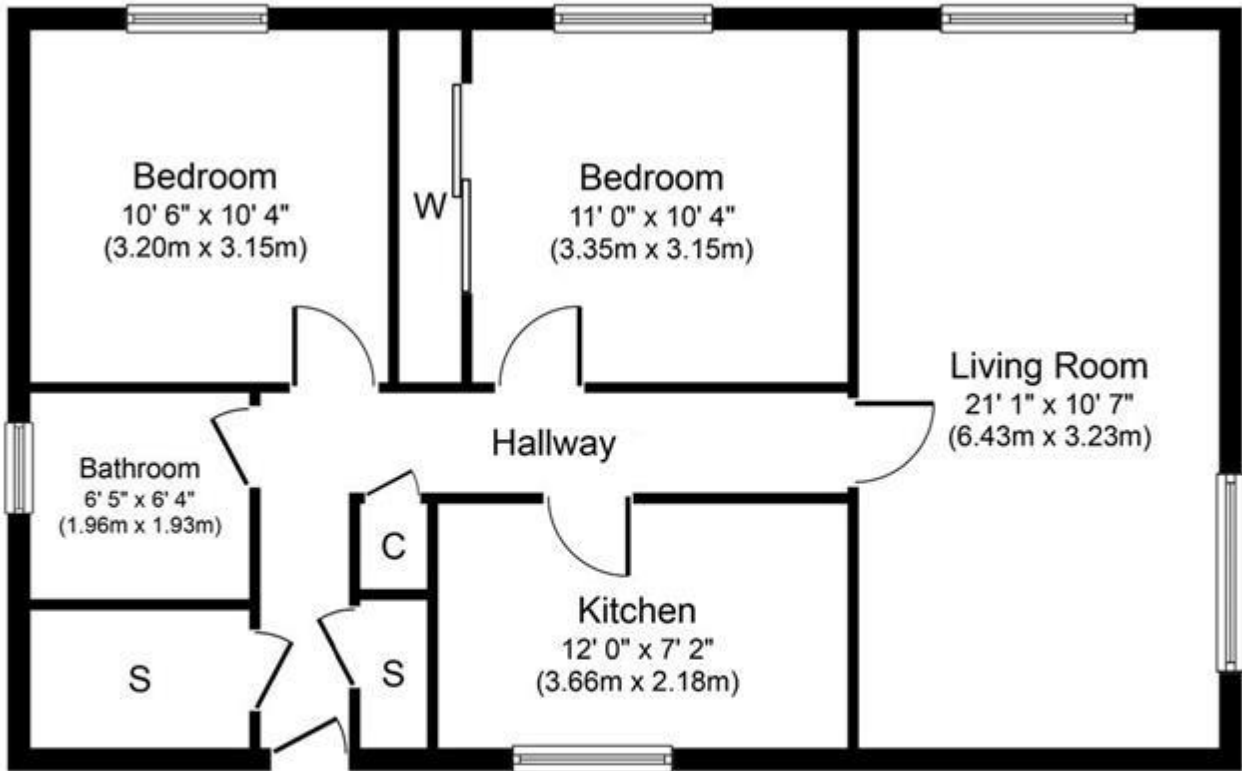

**Approximate Floor Area**  
 735 sq. ft.  
 (68.3 sq. m.)

Whilst every attempt has been made to ensure the accuracy of the floor plan contained here, measurements of doors, windows, rooms and any other items are approximate and no responsibility is taken for any error, omission, or mis-statement. The measurements should not be relied upon for valuation, transaction and/or funding purposes. This plan is for illustrative purposes only and should be used as such by any prospective purchaser or tenant. The services, systems and appliances shown have not been tested and no guarantee as to their operability or efficiency can be given.

Copyright V360 Ltd 2024 | [www.houseviz.com](http://www.houseviz.com)

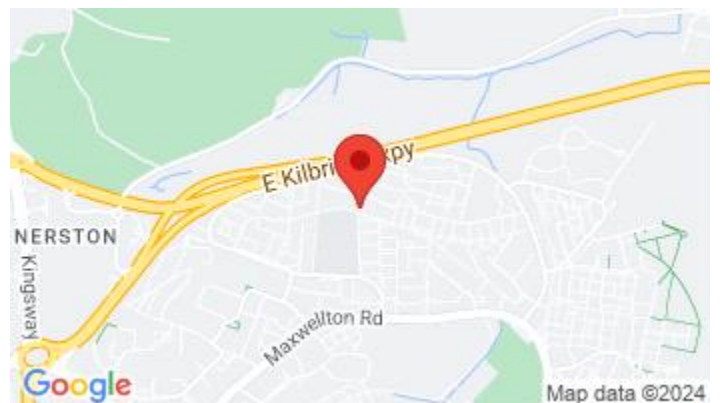

Whilst every effort is made to ensure the accuracy of these details, it should be noted that the measurements are approximate only. Floorplans are for representation purposes only and prepared according to the RICS Code of Measuring Practice by our floorplan provider. Therefore, the layout of doors, windows and rooms are approximate and should be regarded as such by any prospective purchaser. Any internal photographs are intended as a guide only and it should not be assumed that any of the furniture/fitings are included in any sale. Where shown, details of lease, ground rent and service charge are provided by the vendor and their accuracy cannot be guaranteed, as the information may not have been verified and further checks should be made either through your solicitor/conveyance. Where appliances, including central heating, are mentioned, it cannot be assumed that they are in working order, as they have not been tested. Please also note that wiring, plumbing and drains have not been checked.