



PLOT 19 BLAIRHILL GARDENS, BLAIR ROAD, COATBRIDGE

FIXED PRICE £264,000 Freehold

A luxury 3 bedroom semi-detached home offering generous room sizes, an attractive living and dining kitchen layout, plenty of storage and spacious bedrooms. With the added luxury of a stylish en-suite and family bathroom, The Glendhu home is the perfect design for a couple or growing family.

- 3 bed Semi-Detached Villa
- Designer Kitchen with Integrated Appliances
- Family Bathroom & En-Suite with Porcelanosa Tiling
- WC
- Gas Central heating

A luxury 3 bedroom semi-detached home offering generous room sizes, an attractive living and dining kitchen layout, plenty of storage and spacious bedrooms. With the added luxury of a stylish en-suite and family bathroom, The Glendhu home is the perfect design for a couple or growing family.

Blairhill Gardens is centrally located near to Drumpellier, Coatbridge.

Alexander Gardens, Blair Road, Coatbridge, ML5 2EN

You can enjoy the best of town living in close proximity to major motorway links, whilst enjoying lots of open green spaces as soon as you step outside your home.

Your new home is within walking or cycling distance to the beautiful Drumpellier Country Park which covers an area of 500 acres with two natural lochs, moorland, woodlands and grasslands. The park is fantastic for facilities including a visitor centre, café, wildlife displays and adventure playground. You can access the park via a short walk or cycle from your new home along the Monklands Canal Pathway.

Local primary and secondary schools are also within walking distance to Blairhill Gardens, making this the perfect place to call home for your family. You can also make the most of the nearby train station, only a few minute's walk away, to access Glasgow City Centre, Edinburgh and beyond. Or if you prefer to travel by car, the M8 and M74 motorway links are all within a few miles.

The town centre of Coatbridge has a great range of amenities for everyone, including, shops, restaurants, bars, library and leisure centres. A close-by retail park will serve all your shopping needs too.

With your everyday essentials and leisure activities taken care of, make Blairhill Gardens the place you want to be at home and create the life you love.

Tenure: Freehold



PLOT 19 BLAIRHILL GARDENS, BLAIR ROAD, COATBRIDGE
FIXED PRICE £264,000 Freehold

GROUND FLOOR

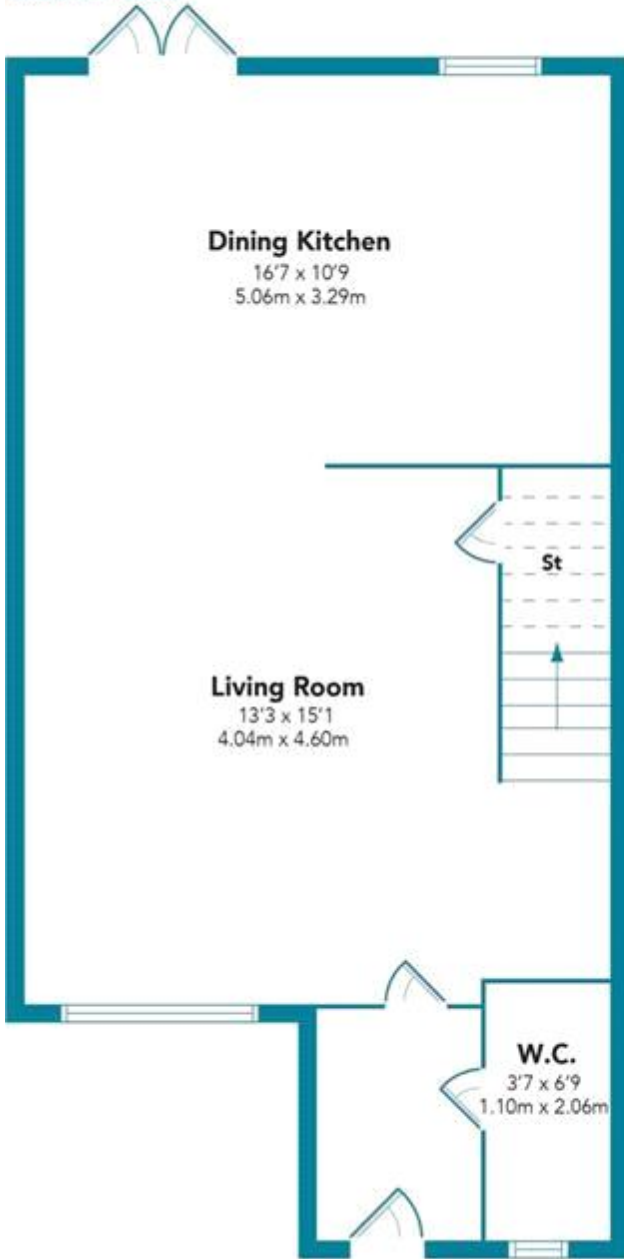

FIRST FLOOR

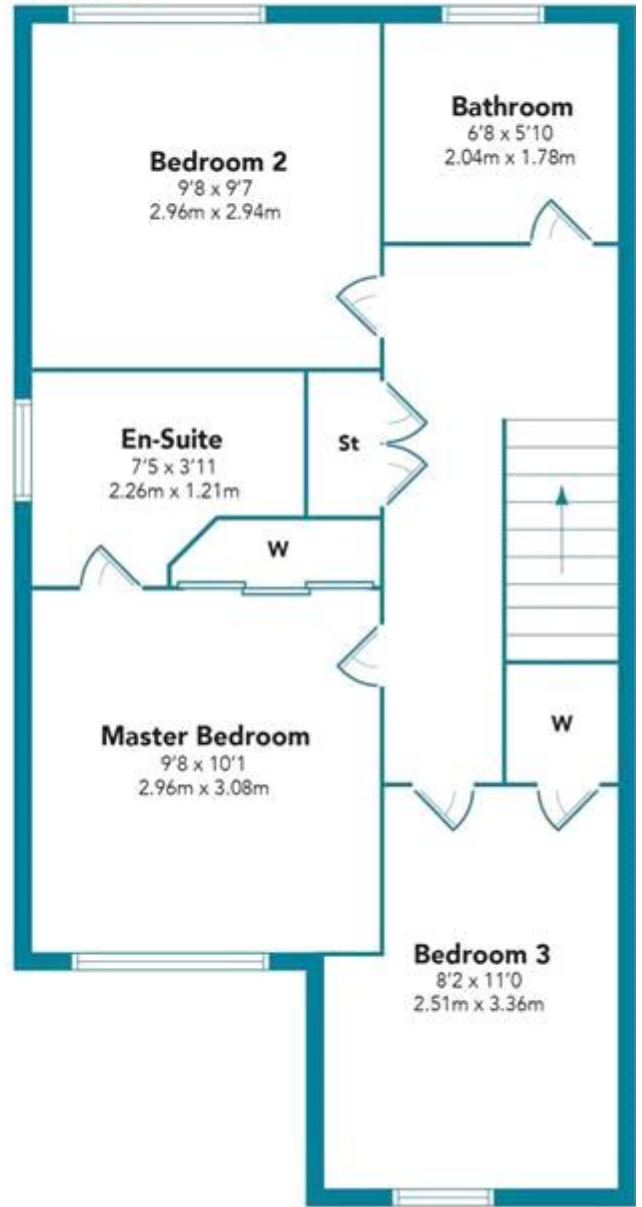

Floorplans are indicative only - not to scale
Produced by Plush Plans Ltd

