



HIGH BURNSIDE AVENUE, COATBRIDGE

OFFERS OVER £140,000 Freehold

Kirkland Estate Agents are proud to present to the market this three bedroom semi detached property, which offers a spacious layout of apartments formed over two levels and should appeal greatly to first time buyers & those wishing to downsize.

Kirkland Estate Agents are proud to present to the market this three bedroom semi detached property, which offers a spacious layout of apartments formed over two levels and should appeal greatly to first time buyers & those wishing to downsize.

This property offers a deceptively spacious layout of well-proportioned apartments that consist of welcoming reception hallway, large airy lounge, modern kitchen, family bathroom and three bedrooms, two of which are double bedrooms with fitted wardrobes.

Features of the property include central heating, double glazing, fitted carpets and flooring front garden, driveway to the side and enclosed rear garden.

The attached floor plan shall provide a detailed layout of this impressive home however we recommend inspection to get a true feel for the layout of accommodation.

Coatbridge Town Centre provides an array of bars, shops, restaurants and many leisure facilities. The property is located close to highly rated primary and secondary schools, and for those commuting by public transport there are regular bus transportation and train station service close by from Blairhill, Kirkwood and Sunnyside to the surrounding towns and cities. For those commuting by car, the M8 and M74 motorways provide easy travel throughout the central belt.

Tenure: Freehold



HIGH BURNSIDE AVENUE, COATBRIDGE
OFFERS OVER £140,000 Freehold

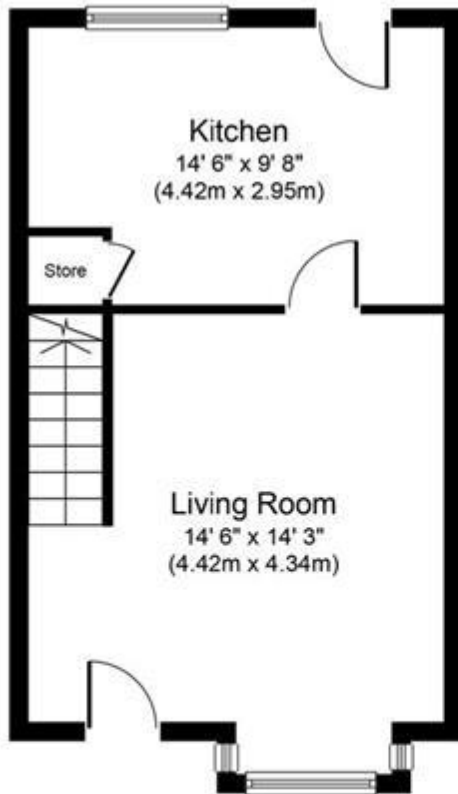

Ground Floor
Approximate Floor Area
361 sq. ft.
(33.6 sq. m.)

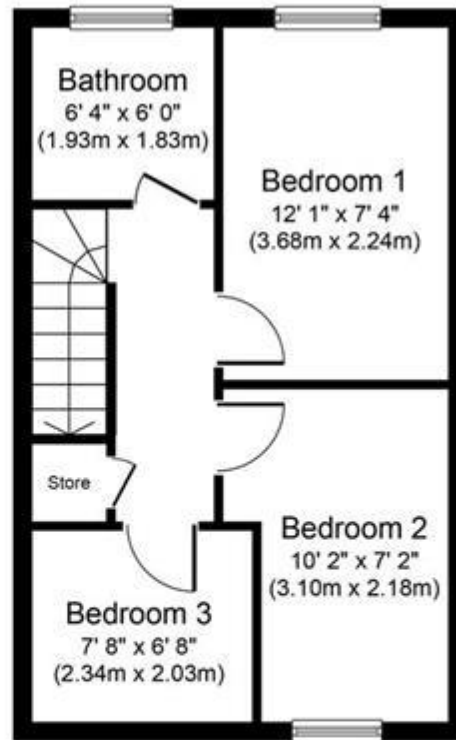

First Floor
Approximate Floor Area
352 sq. ft.
(32.7 sq. m.)

Whilst every attempt has been made to ensure the accuracy of the floor plan contained here, measurements of doors, windows, rooms and any other items are approximate and no responsibility is taken for any error, omission, or mis-statement. The measurements should not be relied upon for valuation, transaction and/or funding purposes. This plan is for illustrative purposes only and should be used as such by any prospective purchaser or tenant. The services, systems and appliances shown have not been tested and no guarantee as to their operability or efficiency can be given.

Copyright V360 Ltd 2024 | www.houseviz.com

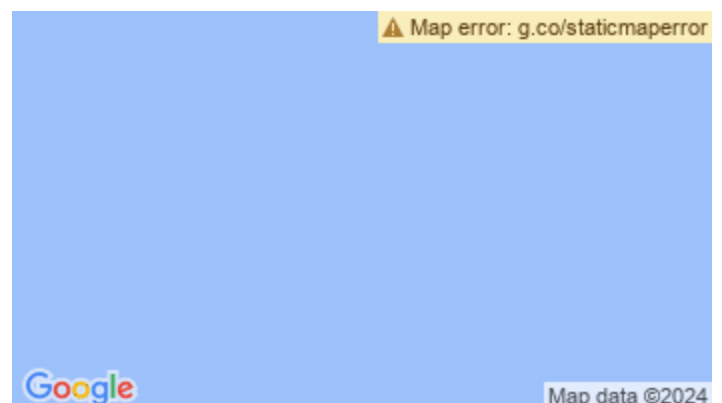

Whilst every effort is made to ensure the accuracy of these details, it should be noted that the measurements are approximate only. Floorplans are for representation purposes only and prepared according to the RICS Code of Measuring Practice by our floorplan provider. Therefore, the layout of doors, windows and rooms are approximate and should be regarded as such by any prospective purchaser. Any internal photographs are intended as a guide only and it should not be assumed that any of the furniture/fittings are included in any sale. Where shown, details of lease, ground rent and service charge are provided by the vendor and their accuracy cannot be guaranteed, as the information may not have been verified and further checks should be made either through your solicitor/conveyance. Where appliances, including central heating, are mentioned, it cannot be assumed that they are in working order, as they have not been tested. Please also note that wiring, plumbing and drains have not been checked.