



THE FAIRWAYS, BOTHWELL, GLASGOW OFFERS OVER £260,000

Occupying an excellent position within the beautifully kept Fairways development lies this spacious ground floor apartment. Offering impressive living throughout, this two bedroom home is versatile with a lovely flow.

Occupying an excellent position within the beautifully kept Fairways development lies this spacious ground floor apartment. Offering impressive living throughout, this two bedroom home is versatile with a lovely flow.

Features include gas central heating, double glazing and a security door entry system with lift access to each floor. The communal gardens are well maintained and factored by Hacking & Paterson with established lawns, bedding areas, trees and shrubs. There is allocated parking with additional visitors spaces.

The accommodation in full comprises; welcoming reception hallway with two large storage cupboards, attractive open plan lounge/dining room, modern kitchen with central island, two excellent sized bedrooms with built in wardrobes and a master en-suite shower room. To complete there is a three piece bathroom.

The Fairways development is home to some of the largest flats within Bothwell and conveniently placed for the Main Street and its amenities. Bothwell and Uddingston are highly regarded for their excellent Main Street where you can find the majority of every day shopping needs. There is a great choice of restaurants, bistros and pubs, with many more found in nearby Hamilton town centre. The property is located within popular school catchments. For those commuting by public transport there are regular bus and train services from Hamilton and Uddingston to the surrounding towns and cities including Glasgow and Edinburgh. The M74 motorway provides excellent access to the central belt linking the surrounding towns and cities.



THE FAIRWAYS, BOTHWELL, GLASGOW
OFFERS OVER £260,000

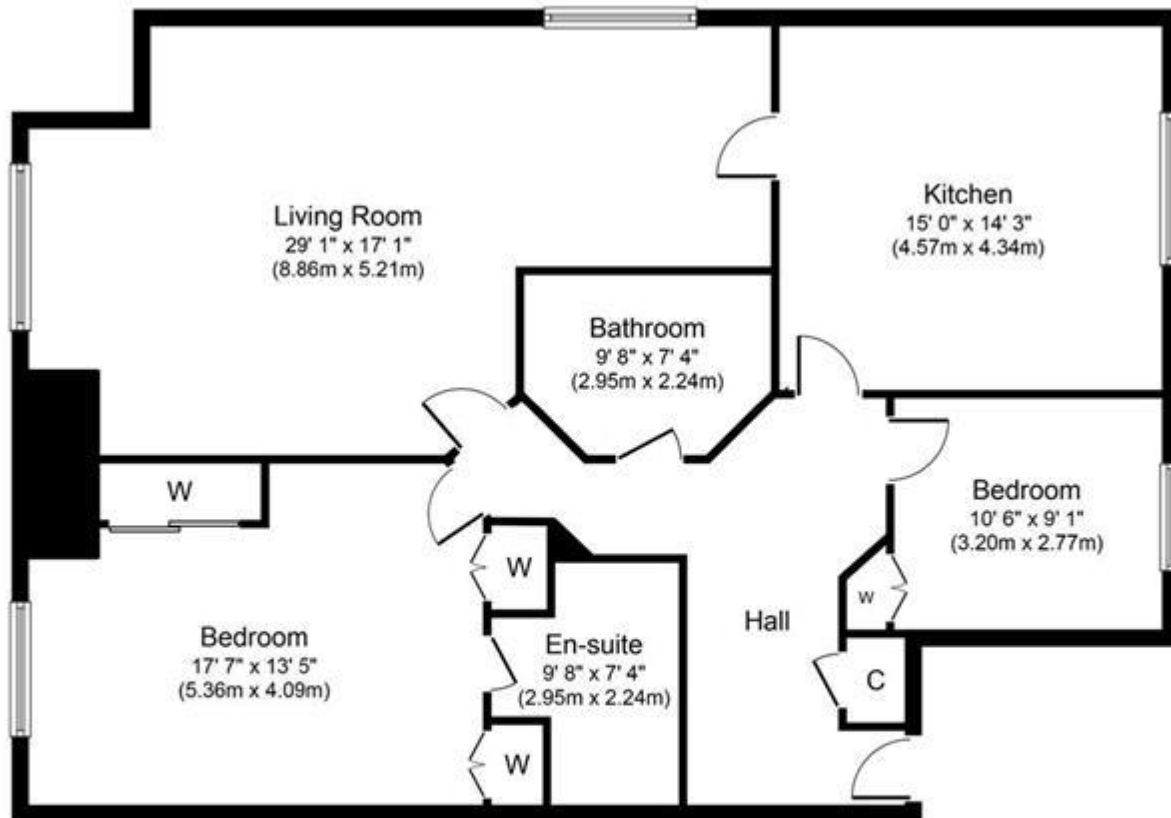

Approximate Floor Area
 1,268 sq. ft.
 (117.8 sq. m.)

Whilst every attempt has been made to ensure the accuracy of the floor plan contained here, measurements of doors, windows, rooms and any other items are approximate and no responsibility is taken for any error, omission, or mis-statement. The measurements should not be relied upon for valuation, transaction and/or funding purposes. This plan is for illustrative purposes only and should be used as such by any prospective purchaser or tenant. The services, systems and appliances shown have not been tested and no guarantee as to their operability or efficiency can be given.

Copyright V360 Ltd 2024 | www.houseviz.com



Whilst every effort is made to ensure the accuracy of these details, it should be noted that the measurements are approximate only. Floorplans are for representation purposes only and prepared according to the RICS Code of Measuring Practice by our floorplan provider. Therefore, the layout of doors, windows and rooms are approximate and should be regarded as such by any prospective purchaser. Any internal photographs are intended as a guide only and it should not be assumed that any of the furniture/fittings are included in any sale. Where shown, details of lease, ground rent and service charge are provided by the vendor and their accuracy cannot be guaranteed, as the information may not have been verified and further checks should be made either through your solicitor/conveyance. Where appliances, including central heating, are mentioned, it cannot be assumed that they are in working order, as they have not been tested. Please also note that wiring, plumbing and drains have not been checked.