



## LOANHEAD STREET, COATBRIDGE OFFERS OVER £105,000

This well proportioned mid terraced villa is positioned within the popular Kirkshaws location of Coatbridge and is ideal for a family or first time buyer.

This well proportioned mid terraced villa is positioned within the popular Kirkshaws location of Coatbridge and is ideal for a family or first time buyer.

This great sized family home has been well maintained and comprises reception hall, bright and airy lounge, fitted kitchen, three bedrooms and a family shower room. Features include quality floor coverings, gas central heating and double glazing.

The floor plan shall provide you with a detailed layout of this well laid out and comfortable home; however, we recommend viewing to appreciate all that's on offer.

Coatbridge has the majority of everyday shopping needs and there is a great choice of restaurants, bistros and pubs. The property is located within school catchments for Kirkshaws and St Timothy's Primary Schools and for those commuting by public transport there are regular bus and train services from Coatbridge to the surrounding towns and cities including Glasgow and Edinburgh. For those commuting by car, the M74 and M8 motorways provide excellent access to the central belt linking the surrounding towns and cities.



LOANHEAD STREET, COATBRIDGE  
OFFERS OVER £105,000



**KIRKLAND**  
ESTATE AGENTS

**GROUND FLOOR**

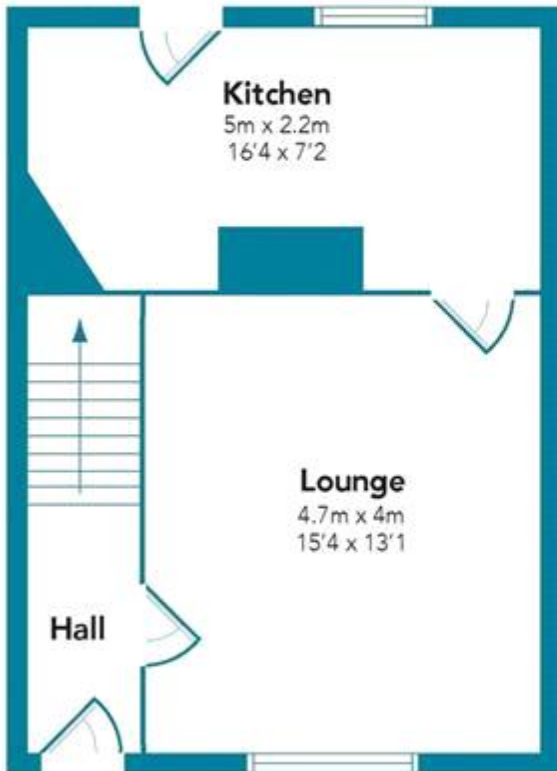

**FIRST FLOOR**

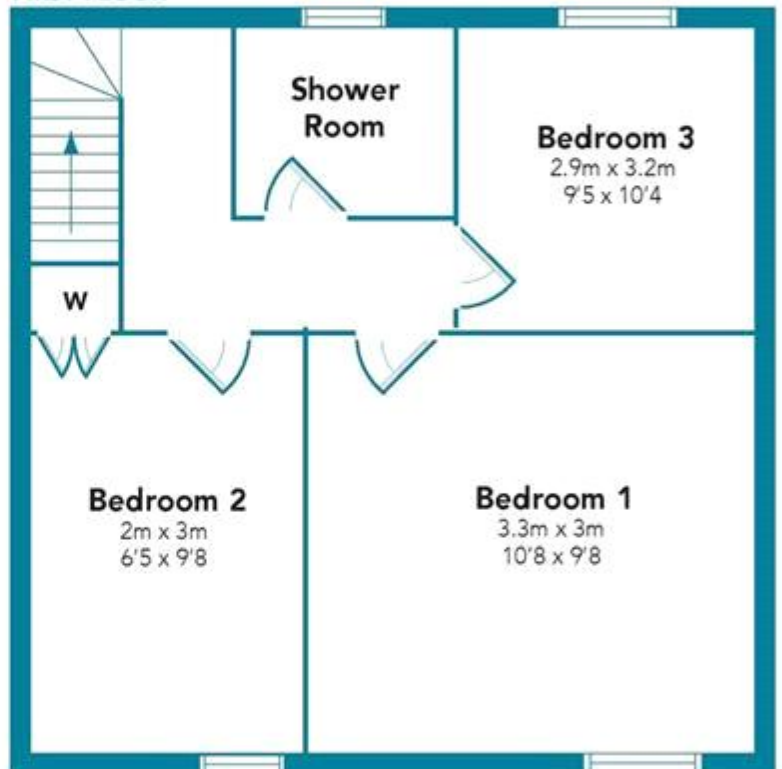

Floorplans are indicative only - not to scale  
Produced by Plush Plans Ltd

▲ Map error: [g.co/staticmaperror](https://g.co/staticmaperror)

Google

Map data ©2024

Whilst every effort is made to ensure the accuracy of these details, it should be noted that the measurements are approximate only. Floorplans are for representation purposes only and prepared according to the RICS Code of Measuring Practice by our floorplan provider. Therefore, the layout of doors, windows and rooms are approximate and should be regarded as such by any prospective purchaser. Any internal photographs are intended as a guide only and it should not be assumed that any of the furniture/fittings are included in any sale. Where shown, details of lease, ground rent and service charge are provided by the vendor and their accuracy cannot be guaranteed, as the information may not have been verified and further checks should be made either through your solicitor/conveyance. Where appliances, including central heating, are mentioned, it cannot be assumed that they are in working order, as they have not been tested. Please also note that wiring, plumbing and drains have not been checked.