



EDINBURGH ROAD, BAILLIESTON OFFERS OVER £195,000

Kirkland Estate Agents are proud to present to the market this four bedroom semi detached family home. Situated within the extremely popular Garrowhill region of Baillieston.

Kirkland Estate Agents are proud to present to the market this four bedroom semi detached family home. Situated within the extremely popular Garrowhill region of Baillieston.

This property is extremely versatile and has a host of living space which is sure to appeal to a whole host of buyers.

The lower level of the property comprises, reception hallway, bathroom, front facing lounge. Modern fitted kitchen and extended dining room.

The upper level has three well sized double bedrooms and following onto the loft which has a floored and lined loft space.

The outside of the property is of huge proportion and boasts the following. Gated entrance, driveway & lawn. The rear of the property has a patio area and a well maintained lawn.

Conveniently located in Edinburgh Road, Baillieston this property offers easy access to excellent schools, local amenities, and transport links. Enjoy the charm of the nearby town center, with its shopping facilities, restaurants, and cafes. The abundance of green spaces, parks, and recreational areas nearby offers endless opportunities for outdoor activities and family outings.



EDINBURGH ROAD, BAILLIESTON
OFFERS OVER £195,000



Ground Floor
Approximate Floor Area
536 sq. ft.
(49.8 sq. m.)

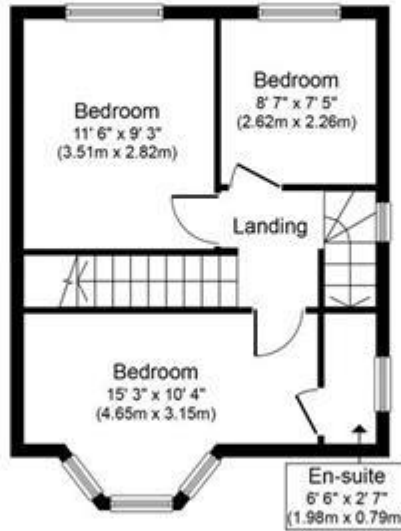

First Floor
Approximate Floor Area
388 sq. ft.
(36.1 sq. m.)

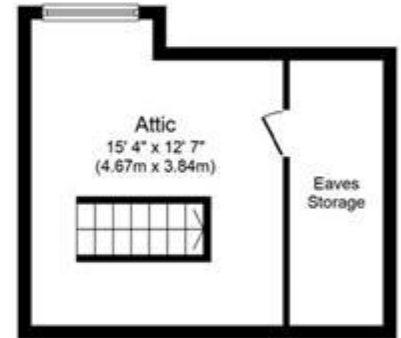

Attic
Approximate Floor Area
246 sq. ft.
(22.8 sq. m.)

Whilst every attempt has been made to ensure the accuracy of the floor plan contained here, measurements of doors, windows, rooms and any other items are approximate and no responsibility is taken for any error, omission, or mis-statement. The measurements should not be relied upon for valuation, transaction and/or funding purposes. This plan is for illustrative purposes only and should be used as such by any prospective purchaser or tenant. The services, systems and appliances shown have not been tested and no guarantee as to their operability or efficiency can be given.

Copyright V360 Ltd 2024 | www.houseviz.com

▲ Map error: g.co/staticmaperror

Google

Map data ©2024

Whilst every effort is made to ensure the accuracy of these details, it should be noted that the measurements are approximate only. Floorplans are for representation purposes only and prepared according to the RICS Code of Measuring Practice by our floorplan provider. Therefore, the layout of doors, windows and rooms are approximate and should be regarded as such by any prospective purchaser. Any internal photographs are intended as a guide only and it should not be assumed that any of the furniture/fitings are included in any sale. Where shown, details of lease, ground rent and service charge are provided by the vendor and their accuracy cannot be guaranteed, as the information may not have been verified and further checks should be made either through your solicitor/conveyance. Where appliances, including central heating, are mentioned, it cannot be assumed that they are in working order, as they have not been tested. Please also note that wiring, plumbing and drains have not been checked.