



ROBERTSON WAY RAVENSCRAIG MOTHERWELL OFFERS OVER £220,000 Freehold

Kirkland Estate Agents are proud to present to the market this immaculately presented three bedroom semi detached family townhouse. Situated within the highly sought-after area of Ravenscraig, Motherwell. The perfect family estate for a growing family.

Kirkland Estate Agents are proud to present to the market this immaculately presented three bedroom semi detached family townhouse. Situated within the highly sought-after area of Ravenscraig, Motherwell. The perfect family estate for a growing family.

The property comprises living space across three levels. The ground floor having a reception hallway, front facing lounge. Dining area, fitted kitchen with a host of integrated appliances & WC.

The first floor having two well sized bedrooms and a family bathroom. With the top floor having again another bedroom and master en suite.

The property is placed on a fantastic plot and has a fantastic rear garden as well as driveway to the front.

The sought-after area of Motherwell boasts a wide and varied range of shops, bars, restaurants, banks and building societies. Local amenities include Showcase Leisure Park, multiplex cinema, bowling alley, sports complex, bowling green, golf course, Chatelherault & Strathclyde Country Park's and Wishaw General Hospital. Motherwell offers primary and secondary educational facilities, access to Hamilton College and bus, rail and motorway links providing access in and around the Central Belt.

Tenure: Freehold



ROBERTSON WAY RAVENSCRAIG MOTHERWELL
OFFERS OVER £220,000 Freehold

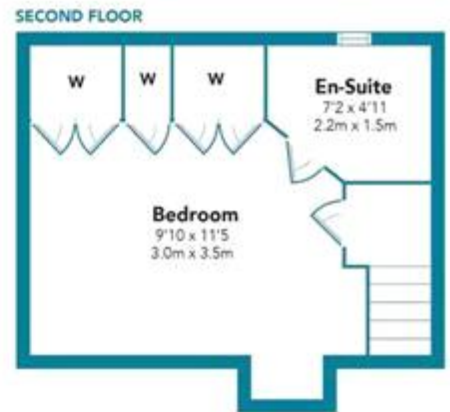
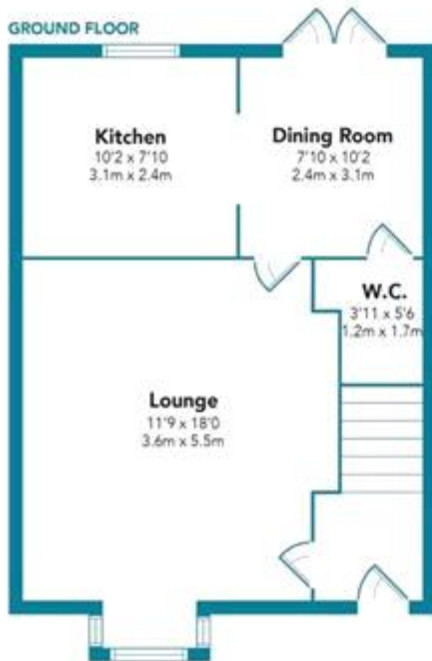

Floorplans are indicative only - not to scale
Produced by Plush Plans Ltd

▲ Map error: g.co/staticmaperror