



DOWNIE CLOSE, GLASGOW OFFERS OVER £275,000

UNDER OFFER

A substantial and stunning detached bungalow occupying a prime position within sought after modern development. The property is in true turn key condition and a credit to the current owner.

A substantial and stunning detached bungalow occupying a prime position within sought after modern development. The property is in true turn key condition and a credit to the current owner.

Providing generously proportioned accommodation formed over one level comprising welcoming reception hall, bright spacious lounge, well equipped fitted kitchen which has a range of base and wall mounted units, dining room/bedroom with patio doors to rear gardens, two other bedrooms and family bathroom complete the accommodation.

The property further features a system of gas central heating, double glazed window units, gardens and driveway. The property also has great storage facilities.

Downie Close is located within the highly regarded Tannochside district of Uddingston and is particularly popular due to the convenience and location of the schools and shops. Uddingston is highly regarded for its excellent Main Street where you can find the majority of every day shopping needs and a great choice of restaurants, bistros and pubs. For those commuting by public transport there are regular bus and train services from Uddingston to the surrounding towns and cities including Glasgow and Edinburgh. The M74 & M8 motorways provide excellent access to the central belt linking the surrounding towns and cities.



**DOWNIE CLOSE, GLASGOW
OFFERS OVER £275,000**

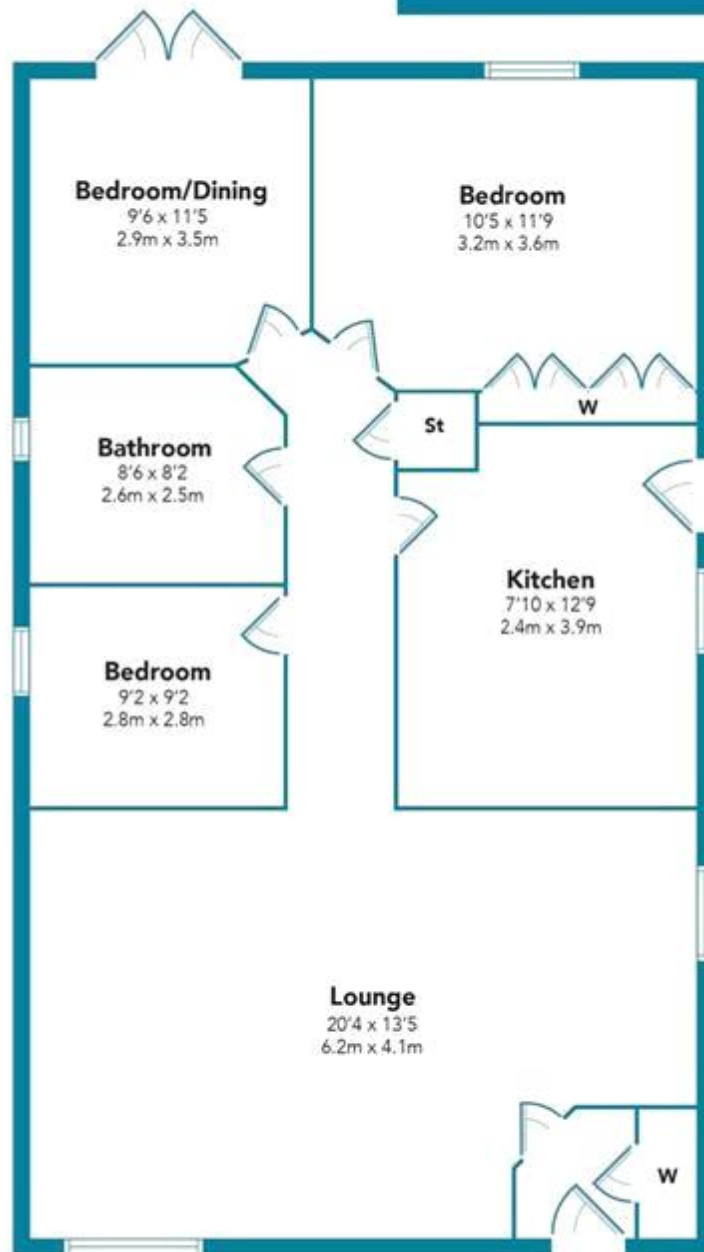

Floorplans are indicative only - not to scale
Produced by Plush Plans Ltd

Map error: g.co/staticmaperror