



CONISTONE CRESCENT, GLASGOW OFFERS OVER £240,000

Kirkland Estate Agents are proud to present to the market this attractive three bedroom detached family home. Situated within a highly sought after locale on a prominent plot.

Kirkland Estate Agents are proud to present to the market this attractive three bedroom detached family home. Situated within a highly sought after locale on a prominent plot.

The property showcases family living space throughout and is sure to appeal to a whole host of buyers.

The ground floor of the property has a large reception hallway, large front facing lounge with dining space to the rear. Fitted kitchen with a whole lot of space and fitted units.

The upstairs of the property has three well sized bedrooms & a family shower room.

The plot itself within the property is a true gem for this property, with both large front, side & rear space.

The property has a well maintained lawn, large & private patio space. Garage & driveway.

Garrowhill enjoys a large number of local amenities that include primary and high schools, shops, supermarkets, public transport facilities and easy access to Glasgow and beyond via both railway and motorway networks.



CONISTONE CRESCENT, GLASGOW
OFFERS OVER £240,000

GROUND FLOOR

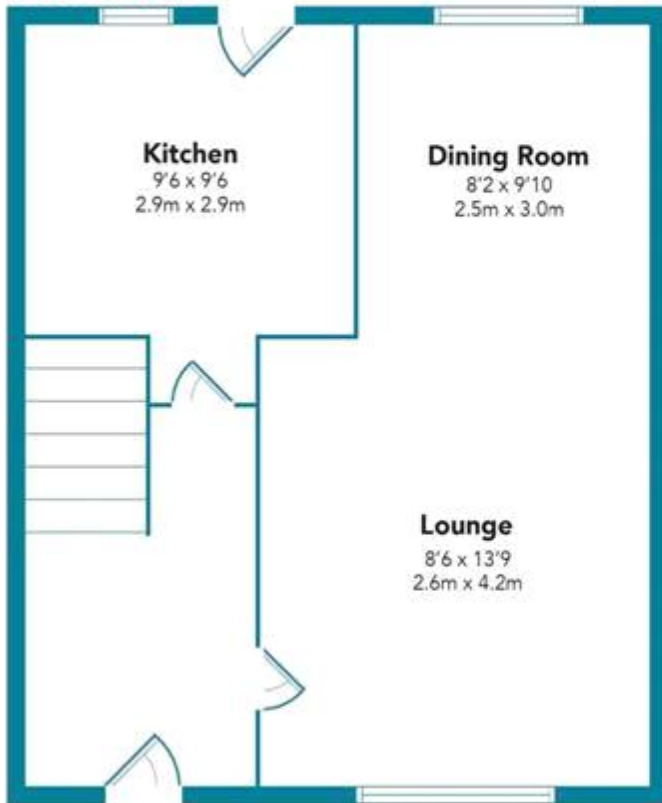

FIRST FLOOR

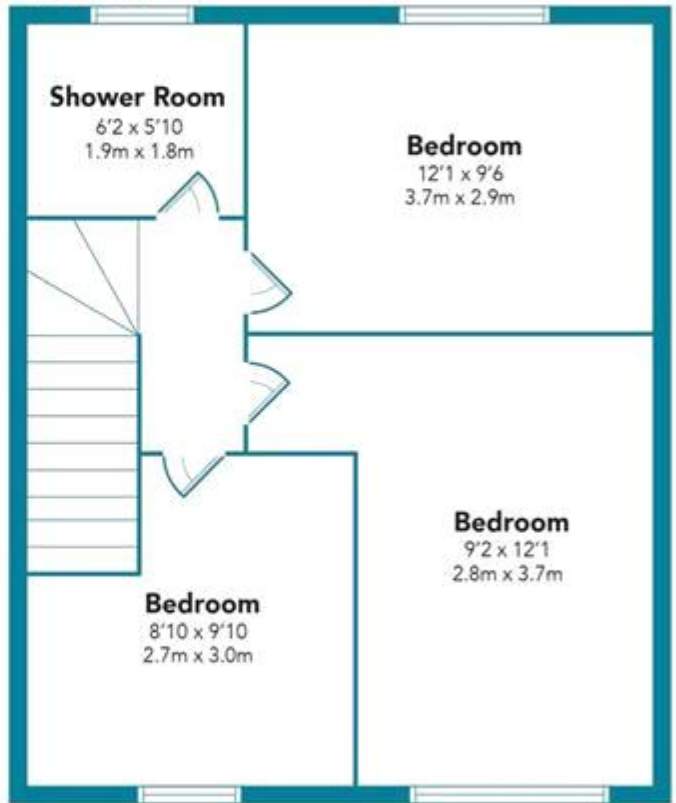

Floorplans are indicative only - not to scale
Produced by Plush Plans Ltd

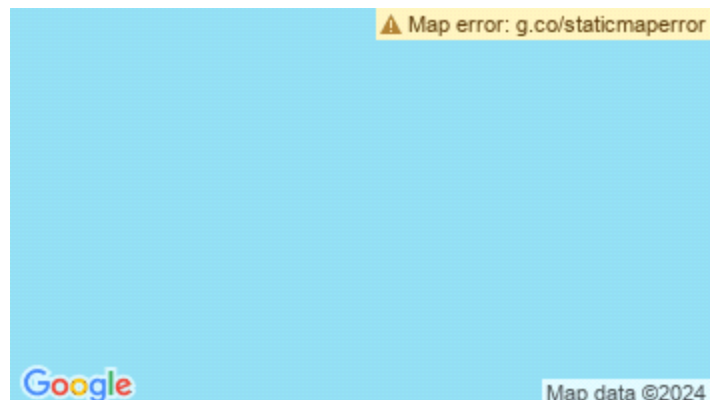

Whilst every effort is made to ensure the accuracy of these details, it should be noted that the measurements are approximate only. Floorplans are for representation purposes only and prepared according to the RICS Code of Measuring Practice by our floorplan provider. Therefore, the layout of doors, windows and rooms are approximate and should be regarded as such by any prospective purchaser. Any internal photographs are intended as a guide only and it should not be assumed that any of the furniture/fittings are included in any sale. Where shown, details of lease, ground rent and service charge are provided by the vendor and their accuracy cannot be guaranteed, as the information may not have been verified and further checks should be made either through your solicitor/conveyance. Where appliances, including central heating, are mentioned, it cannot be assumed that they are in working order, as they have not been tested. Please also note that wiring, plumbing and drains have not been checked.