



## **BURNHEAD STREET, UDDINGSTON, GLASGOW OFFERS OVER £99,995**

Kirkland Estate Agents are proud to present to the market this two bedroom end terrace family home, placed within this large end terrace plot whilst being located within Viewpark, Uddingston.

Kirkland Estate Agents are proud to present to the market this two bedroom end terrace family home, placed within this large end terrace plot whilst being located within Viewpark, Uddingston.

The property comprises a host of accommodation over two levels with the lower having a front facing lounge, fitted kitchen with access to the rear garden.

The upstairs has two well sized bedrooms and a fitted bathroom.

The outside is of great proportion and has a large front and rear garden.

Burnhead Street. is located in the popular Viewpark area in Uddingston close to local shops with further shopping and supermarkets found in the Main Street. Uddingston offers great transport links due to its close proximity to the M8 & M74 motorways. There is also a train station with regular services to Glasgow and Edinburgh. The placement of the house also means it is within the catchment area for popular schooling.





**BURNHEAD STREET, UDDINGSTON, GLASGOW**  
**OFFERS OVER £99,995**

GROUND FLOOR

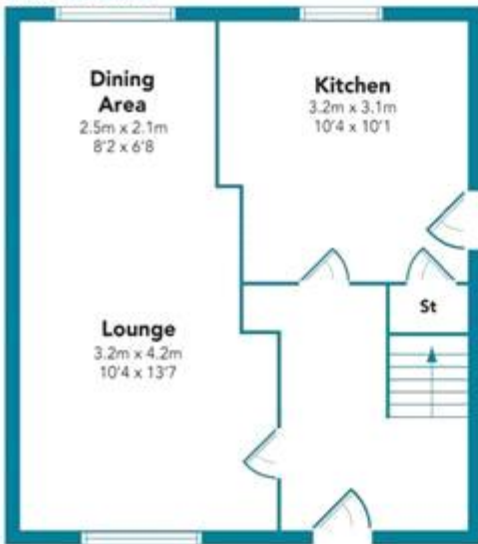

FIRST FLOOR

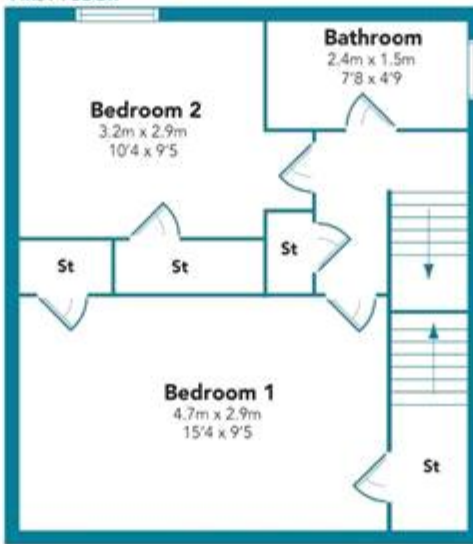

LOFT

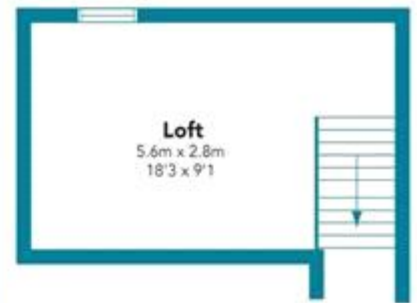

Floorplans are indicative only - not to scale  
Produced by Plush Plans Ltd



Whilst every effort is made to ensure the accuracy of these details, it should be noted that the measurements are approximate only. Floorplans are for representation purposes only and prepared according to the RICS Code of Measuring Practice by our floorplan provider. Therefore, the layout of doors, windows and rooms are approximate and should be regarded as such by any prospective purchaser. Any internal photographs are intended as a guide only and it should not be assumed that any of the furniture/fittings are included in any sale. Where shown, details of lease, ground rent and service charge are provided by the vendor and their accuracy cannot be guaranteed, as the information may not have been verified and further checks should be made either through your solicitor/conveyance. Where appliances, including central heating, are mentioned, it cannot be assumed that they are in working order, as they have not been tested. Please also note that wiring, plumbing and drains have not been checked.