



## COLTSWOOD ROAD, COATBRIDGE OFFERS OVER £169,995 Freehold

Kirkland Estate Agents are proud to present to the market this three bedroom semi detached family home. Perfectly placed on this huge plot on the popular area of Greenhill, within Coatbridge. EPC Rating: C.

Kirkland Estate Agents are proud to present to the market this three bedroom semi detached family home. Perfectly placed on this huge plot on the popular area of Greenhill, within Coatbridge. EPC Rating: C.

The property showcases excellent living space throughout and is sure to appeal to a whole host of buyers.

The property has large living space on the ground floor with a reception hallway, wc, front facing lounge, modern fitted kitchen with dining space & conservatory.

The upstairs of the property has three well sized bedrooms & newly fitted family bathroom.

The property also benefits from large outdoor space, mainly laid with lawn, whilst also having slabbed, chipped & decking patio space.

Coatbridge is home to excellent schools, shopping facilities, sports amenities, swimming baths and parks. There is also a wide variety of restaurants, bistros and pubs. For those commuting by public transport there are regular bus and train services from Coatbridge to the surrounding towns and cities including Glasgow and Edinburgh. The nearby M74 and M8 motorways provide excellent road links throughout the West of Scotland.

Council Tax Band: C

Tenure: Freehold



**COLTSWOOD ROAD, COATBRIDGE**  
**OFFERS OVER £169,995** Freehold

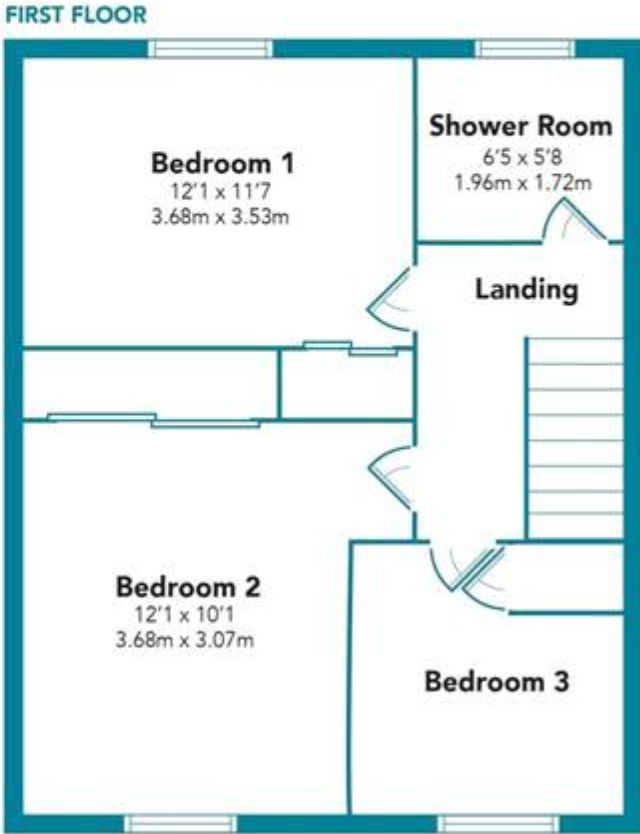
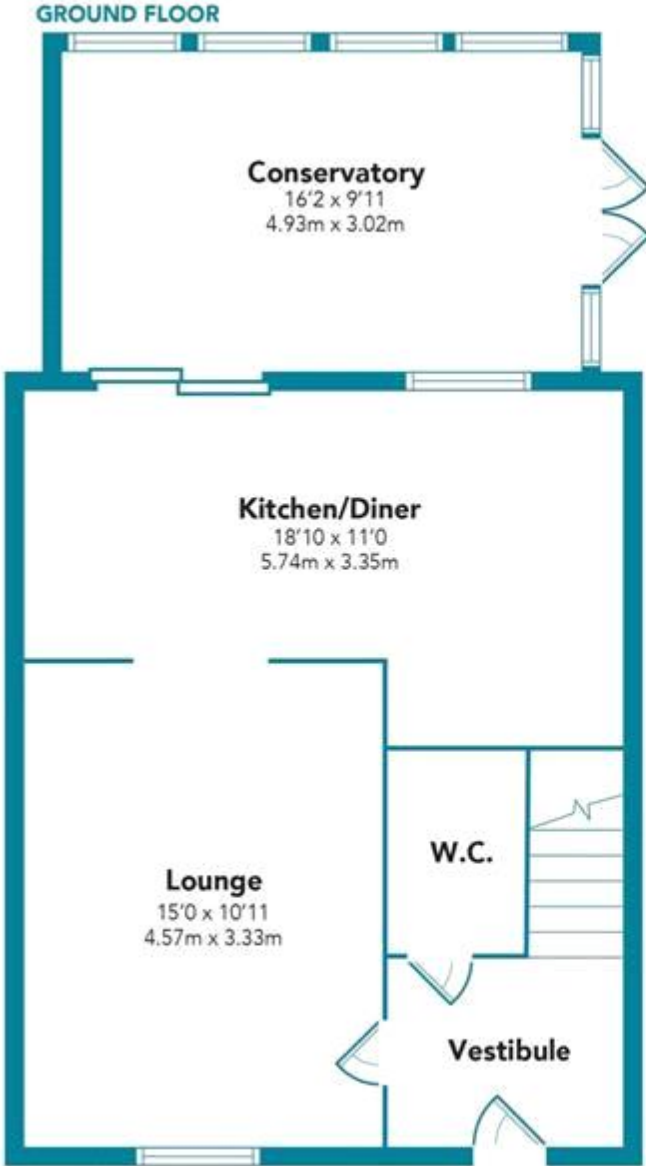

Floorplans are indicative only - not to scale  
Produced by Plush Plans Ltd

Energy Efficiency Rating		Current	Potential
<i>Very energy efficient - lower running costs</i>			
(92-100) <b>A</b>			
(81-91) <b>B</b>			
(69-80) <b>C</b>			
(56-68) <b>D</b>			
(39-54) <b>E</b>			
(21-38) <b>F</b>			
(1-20) <b>G</b>			
<i>Not energy efficient - higher running costs</i>			
<b>Scotland</b>			

The energy efficiency rating is a measure of the overall efficiency of a home. The higher the rating the more energy efficient the home is and the lower the fuel bills will be.



Whilst every effort is made to ensure the accuracy of these details, it should be noted that the measurements are approximate only. Floorplans are for representation purposes only and prepared according to the RICS Code of Measuring Practice by our floorplan provider. Therefore, the layout of doors, windows and rooms are approximate and should be regarded as such by any prospective purchaser. Any internal photographs are intended as a guide only and it should not be assumed that any of the furniture/fitments are included in any sale. Where shown, details of lease, ground rent and service charge are provided by the vendor and their accuracy cannot be guaranteed, as the information may not have been verified and further checks should be made either through your solicitor/conveyance. Where appliances, including central heating, are mentioned, it cannot be assumed that they are in working order, as they have not been tested. Please also note that wiring, plumbing and drains have not been checked.