



## OLD GLASGOW ROAD, GLASGOW OFFERS OVER £147,500

Kirkland Estate Agents are proud to present to the market this rarely available two bedroom mid terrace with a fantastic outlook and is only a stone throws away from Uddingston's Main Street.

Kirkland Estate Agents are proud to present to the market this rarely available two bedroom mid terrace with a fantastic outlook and is only a stone throws away from Uddingston's Main Street.

The accommodation comprises of a large open plan lounge/dining area, a modern fitted kitchen with ample workspace, fully fitted bathroom and two double bedrooms. Further benefits are gas c.h., double glazing, ample storage and well-kept gardens.

The village of Uddingston is held in high regard with its excellent Main Street providing an abundance of shops, cafes, pubs, restaurants and every day shopping needs. The area benefits from an array of leisure facilities including gyms, swimming and sports complexes, a bowling and tennis club, a cricket and sports club, a number of children's play areas, Bothwell Castle, nature walks and the nearby Bothwell and Calderbraes golf courses. Uddingston also benefits from its very own Train Station which provides a regular service to both Glasgow and Edinburgh City Centres as well as connecting throughout the rest of the UK. The M8, M73 and recently extended M74 motorways are nearby which provide excellent access to nearby towns such as Hamilton, Motherwell, East Kilbride and around the central belt. Ample bus services are also available providing access to the surrounding towns within the Lanarkshire area as well as Glasgow city centre. The location is very attractive to families with popular schooling in the area including Uddingston Grammar School.





OLD GLASGOW ROAD, GLASGOW  
OFFERS OVER £147,500

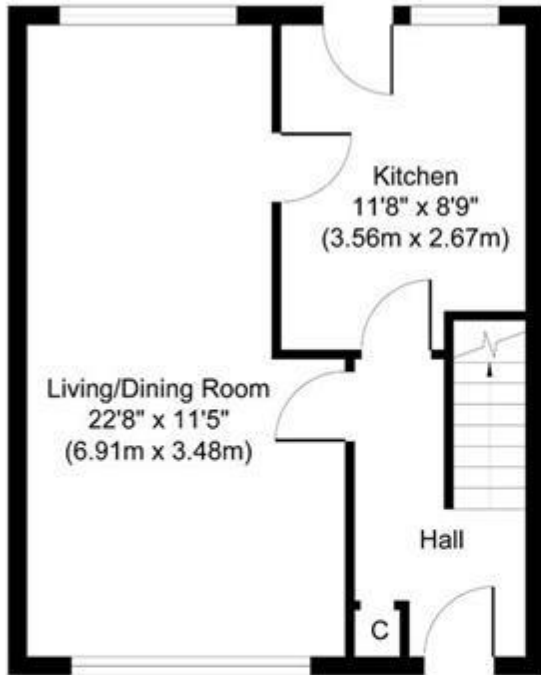

**Ground Floor**  
**Approximate Floor Area**  
**405 sq. ft**  
**(37.64 sq. m)**

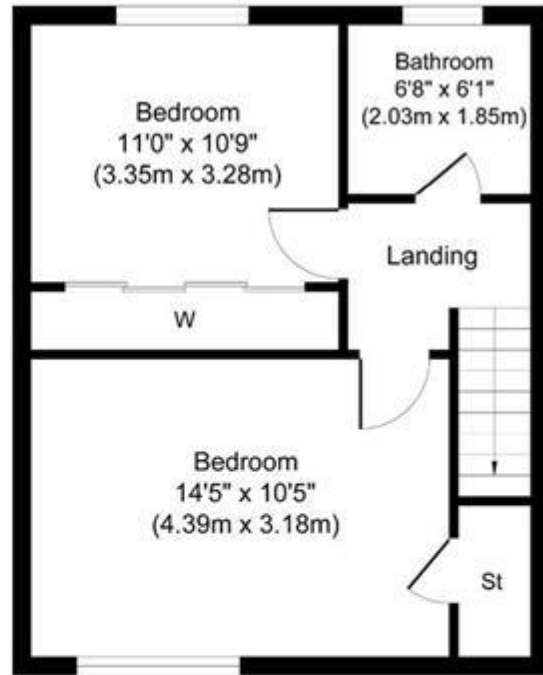

**First Floor**  
**Approximate Floor Area**  
**405 sq. ft**  
**(37.64 sq. m)**

Whilst every attempt has been made to ensure the accuracy of the floor plan contained here, measurements of doors, windows, rooms and any other items are approximate and no responsibility is taken for any error, omission, or mis-statement. The measurements should not be relied upon for valuation, transaction and/or funding purposes. This plan is for illustrative purposes only and should be used as such by any prospective purchaser or tenant. The services, systems and appliances shown have not been tested and no guarantee as to their operability or efficiency can be given.  
 Copyright V360 Ltd 2024 | www.houseviz.com



Whilst every effort is made to ensure the accuracy of these details, it should be noted that the measurements are approximate only. Floorplans are for representation purposes only and prepared according to the RICS Code of Measuring Practice by our floorplan provider. Therefore, the layout of doors, windows and rooms are approximate and should be regarded as such by any prospective purchaser. Any internal photographs are intended as a guide only and it should not be assumed that any of the furniture/fittings are included in any sale. Where shown, details of lease, ground rent and service charge are provided by the vendor and their accuracy cannot be guaranteed, as the information may not have been verified and further checks should be made either through your solicitor/conveyance. Where appliances, including central heating, are mentioned, it cannot be assumed that they are in working order, as they have not been tested. Please also note that wiring, plumbing and drains have not been checked.