

BANYAN CRESCENT, UDDINGSTON, GLASGOW OFFERS OVER £125,000

Kirkland Estate Agents are proud to present to the market this two bedroom end terrace family home, placed within this fantastic plot, centrally within Viewpark, Uddingston. EPC Rating C.

Kirkland Estate Agents are proud to present to the market this two bedroom end terrace family home, placed within this fantastic plot, centrally within Viewpark, Uddingston.

The property comprises a host of accommodation over two levels with the lower having a front facing lounge, fitted kitchen with access to the rear garden.

The upstairs has two well sized bedrooms and a modern fitted bathroom.

The outside is of great proportion and has a front, rear and side garden and a single detached garage.

Banyan Crescent is located in the popular Viewpark area in Uddingston close to local shops with further shopping and supermarkets found in the Main Street. Uddingston offers great transport links due to its close proximity to the M8 & M74 motorways. There is also a train station with regular services to Glasgow and Edinburgh. The placement of the house also means it is within the catchment area for popular schooling.



**BANYAN CRESCENT, UDDINGSTON, GLASGOW
OFFERS OVER £125,000**

GROUND FLOOR

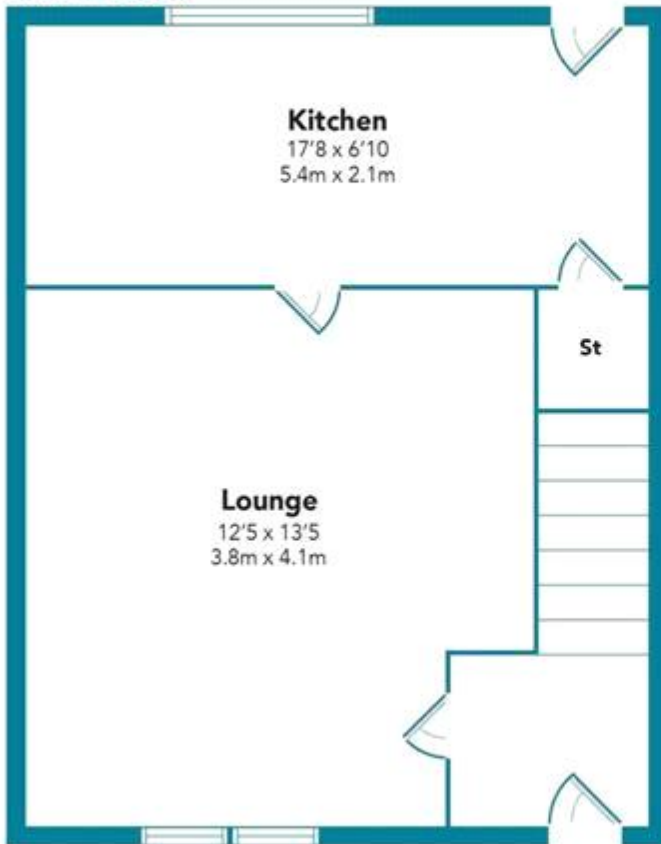

FIRST FLOOR

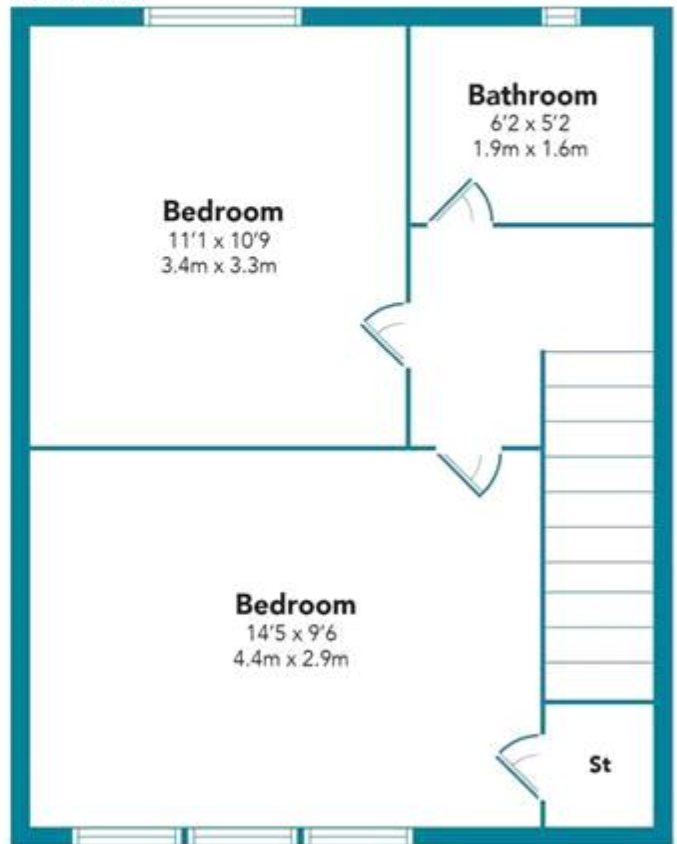

Floorplans are indicative only - not to scale
Produced by Plush Plans Ltd 

